

COUNTRY Poland
CASE STUDY CODE Poland_Good Practice_O.10_05

MAIN INFORMATION

Title Course 'Social participation in spatial planning' at the Faculty of Geographical Sciences

Location Lodz, Poland

Responsible Authority University of Lodz

Link

Keywords Local communities, needs diagnosis, real-world scenarios

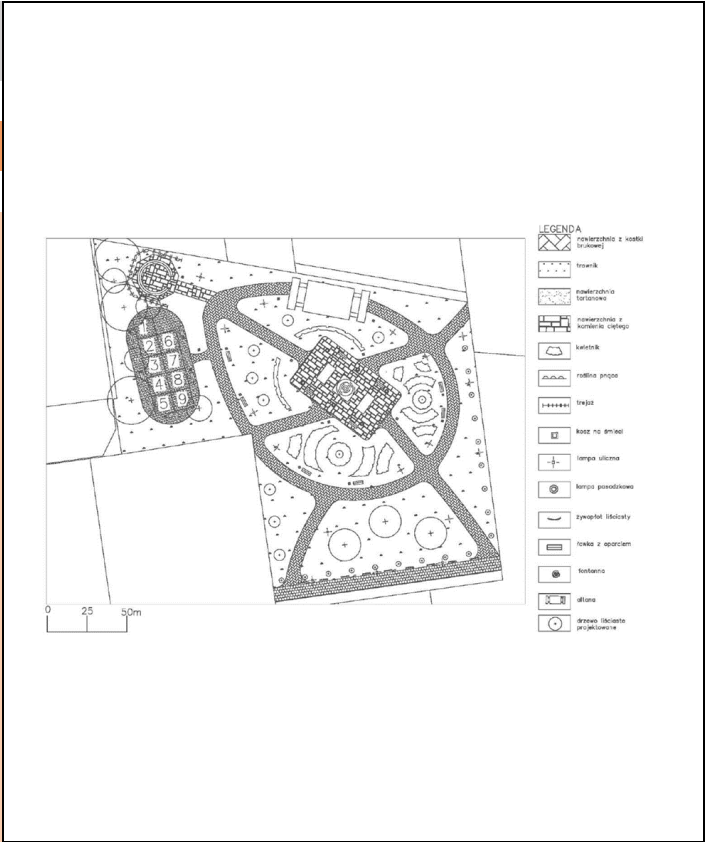

IDENTIFICATION

Type	Case (plan, program, project etc.)	<input type="checkbox"/>	Stakeholders involved	Public institutions	<input type="checkbox"/>
	Method / Tool	<input type="checkbox"/>		Private sector	<input type="checkbox"/>
	Organisation	<input type="checkbox"/>		Civil society organisations	<input type="checkbox"/>
	Legal framework	<input type="checkbox"/>		Knowledge institutions	<input checked="" type="checkbox"/>
	Other <input type="text" value="Course"/>	<input checked="" type="checkbox"/>		Public or grassroots movements	<input type="checkbox"/>
Policy field	Urban planning	<input type="checkbox"/>	Other	<input type="text"/>	<input type="checkbox"/>
	Mobility	<input type="checkbox"/>	Timeline	Start date	<input type="text"/>
	Tourism	<input type="checkbox"/>		End date	<input type="text"/>
	Other <input type="text" value="Local development"/>	<input checked="" type="checkbox"/>		On going	<input checked="" type="checkbox"/>
				Completed	<input type="checkbox"/>
		Limited		<input type="checkbox"/>	
Spatial level	National	<input type="checkbox"/>	Repeated overtime	<input checked="" type="checkbox"/>	
	Regional	<input type="checkbox"/>			
	Local	<input checked="" type="checkbox"/>			



CONTENT AND RESULTS

Purpose and context

The aim of the course 'Social participation in spatial planning' is to show the role of participatory activities in modern society as a method of solving or counteracting problems in local communities. Students will learn what can be regulated through participation and what tools can be used to implement it.

Problems and challenges

Organizing, Supporting and Funding Entities

Process (including participant recruitment & selection) and Interaction/Participation (including methods/tools) used

To pass the course, students prepare a final paper in groups, consisting in coming up with a task for the participatory budget of the city of Lodz. The work consists of the following parts:

- Justification of the choice of the task and the needs for its implementation - Diagnosis of the needs of the local community and users of s public space, justification of the need to implement the task.
- Beneficiaries of the proposed task - Stakeholder analysis using mapping approach. Students determine both the level of influence and interest of individual project stakeholders (table) and the method of their involvement and communication (matrix).
- Location - Characteristics of the location of the plot where the project is to be implemented (address, description, map showing the current development, photographic documentation). Indicating a specific place: a street with a number, the premises of an institution or facility, a park.
- Task description - Detailed description of activities, stages of project implementation.
- Cost estimate - Description of the estimated costs of implementing the task (table) along with their detailed justification (description).





- Information about the rules of accessibility of the proposed task - Students are asked to provide for whom, on what hours, days of the week or month the indicated project is available and whether the use is paid or free of charge, etc.

Outcomes, Effects and Lessons Learned

This kind of tasks allows students to apply theoretical knowledge to real-world scenarios, fostering a deeper understanding of the subject matter. Furthermore, active participation in such tasks promotes collaboration and communication skills, essential for effectively engaging with diverse stakeholders in the planning process. It sensitizes students as future planners.

Bibliography

